



THE TEXAS A&M UNIVERSITY SYSTEM

FACTS 2021

# THE TEXAS A&M UNIVERSITY SYSTEM

tamus.edu | 979-458-6000

The Texas A&M University System Headquarters

301 Tarrow St.

College Station, TX 77840-7896

THE TEXAS A&M UNIVERSITY SYSTEM was officially established in 1948 and has evolved into one of the largest systems of higher education in the nation, with a statewide network of 11 universities, including our flagship, Texas A&M University, and ten regional universities across the state. Additionally, the A&M System provides service and education to the people of Texas and beyond through eight state agencies and a System administration office.

Each of the A&M System members has its own unique mission, history and goals. Together, they provide research, educational programs and community enhancement services that improve the lives of people in Texas and around the world.

A&M System universities educate over 152,000 students and make more than 24 million additional educational contacts through service and outreach programs each year.

With more than 26,000 faculty and staff positions, the A&M System has a physical presence in 250 of the state's 254 counties and a programmatic presence in every county. The A&M System has real property holdings totaling more than 63,000 surface acres and 62,000 mineral acres.

System-wide, externally funded research expenditures exceed \$1 billion to help drive the state's economy.

The A&M System, with a total operating budget of \$6.3 billion, is governed by a nine-member Board of Regents. A nonvoting student member was added in 2006. The regents appoint the chancellor, the chief executive officer who oversees the direction and operation of the System. The System's role is governed by the state's education code, Title 3, chiefly Ch. 51, Sec. 51.353 and Ch. 85, Sec. 85.17.

tamus.edu

 @tamusystem

 @tamusystem

 tamusedu

 The Texas A&M University System

★ UNIVERSITIES

- TEXAS A&M UNIVERSITY

**John L. Junkins**, Interim President

[tamu.edu](http://tamu.edu)
- TEXAS A&M UNIVERSITY AT GALVESTON

**Michael E. Fossum**, Vice President and COO

[tamug.edu](http://tamug.edu)
- TEXAS A&M UNIVERSITY AT QATAR

**César Malavé**, Dean

[www.qatar.tamu.edu](http://www.qatar.tamu.edu)
- PRAIRIE VIEW A&M UNIVERSITY

**Ruth J. Simmons**, President

[pvamu.edu](http://pvamu.edu)
- TARLETON STATE UNIVERSITY

**James Hurley**, President

[tarleton.edu](http://tarleton.edu)
- TEXAS A&M INTERNATIONAL UNIVERSITY

**Pablo Arenaz**, President

[tamiu.edu](http://tamiu.edu)
- TEXAS A&M UNIVERSITY-CORPUS CHRISTI

**Kelly Miller**, President

[tamucc.edu](http://tamucc.edu)
- TEXAS A&M UNIVERSITY-KINGSVILLE

**Mark Hussey**, President

[tamuk.edu](http://tamuk.edu)
- WEST TEXAS A&M UNIVERSITY

**Walter V. Wendler**, President

[wtamu.edu](http://wtamu.edu)
- TEXAS A&M UNIVERSITY-COMMERCE

**Mark Rudin**, President

[tamuc.edu](http://tamuc.edu)
- TEXAS A&M UNIVERSITY-TEXARKANA

**Emily Fourmy Cutrer**, President

[tamut.edu](http://tamut.edu)
- TEXAS A&M UNIVERSITY-CENTRAL TEXAS

**Marc A. Nigliazzo**, President

[tamuct.edu](http://tamuct.edu)
- TEXAS A&M UNIVERSITY-SAN ANTONIO

**Cynthia Teniente-Matson**, President

[tamusa.edu](http://tamusa.edu)

▲ Emergency Management Agency

- TEXAS DIVISION OF EMERGENCY MANAGEMENT

**Nim Kidd**

Vice Chancellor for Disaster and Emergency Services

[tdem.texas.gov](http://tdem.texas.gov)

AGENCIES

- ★ Headquarters
- Agricultural Agencies

**Patrick J. Stover**, Vice Chancellor and Dean Agriculture and Life Sciences

[agrilife.tamu.edu](http://agrilife.tamu.edu)

TEXAS A&M AGRILIFE RESEARCH

**Patrick J. Stover**, Director

[agriliferesearch.tamu.edu](http://agriliferesearch.tamu.edu)

TEXAS A&M AGRILIFE EXTENSION SERVICE

**Jeff Hyde**, Director

[agrilifeextension.tamu.edu](http://agrilifeextension.tamu.edu)

TEXAS A&M FOREST SERVICE

**Thomas G. Boggus**, Director and State Forester

[tfsweb.tamu.edu](http://tfsweb.tamu.edu)

TEXAS A&M VETERINARY MEDICAL DIAGNOSTIC LABORATORY

**Bruce L. Akey**, Director

[tvmdl.tamu.edu](http://tvmdl.tamu.edu)
- Engineering Agencies

**M. Katherine Banks**, Vice Chancellor and Dean of Engineering

[engineering.tamu.edu](http://engineering.tamu.edu)

TEXAS A&M ENGINEERING EXPERIMENT STATION

**M. Katherine Banks**, Director

[tees.tamu.edu](http://tees.tamu.edu)

TEXAS A&M ENGINEERING EXTENSION SERVICE

**David Coatney**, Director

[teex.org](http://teex.org)

TEXAS A&M TRANSPORTATION INSTITUTE

**Gregory D. Winfree**, Director

[tti.tamu.edu](http://tti.tamu.edu)

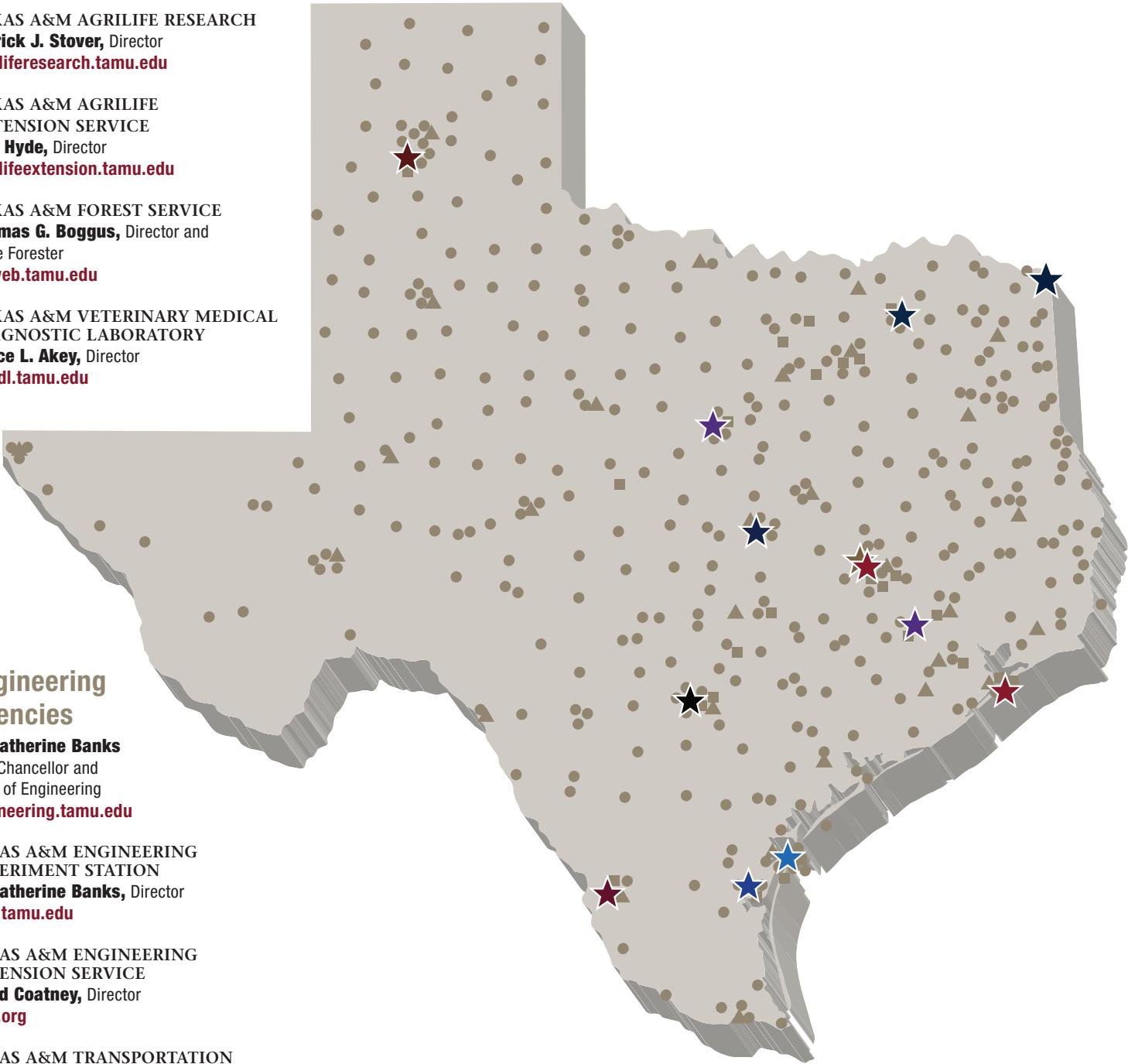



## Board of Regents



**Elaine Mendoza** was appointed to the Board of Regents by Governor Perry in 2011 and reappointed by Governor Abbott in 2017. She served two terms as Vice Chairman from 2015 to 2019 and was elected Chairman on May 17, 2019. Ms. Mendoza served four terms as Chairman of the Committee on Academic and Student Affairs. She also served as a member of the Committee on Audit, the Committee on Finance and as a liaison to the Texas Higher Education Coordinating Board. Her term expires February 1, 2023.



**Tim Leach** was appointed to the Board of Regents by Governor Abbott in 2017. He was elected Vice Chairman on May 17, 2019. He served as Chairman of the Committee on Buildings and Physical Plant and currently serves as a member of that committee. Mr. Leach is serving his second term as a member of the Committee on Finance. He is also a liaison to the Development Foundations of A&M System Members and the Panhandle Plains Museum. His term expires February 1, 2023.



**Phil Adams** was first appointed by Governor Perry in 2001, again in 2009 and was reappointed in 2015 by Governor Abbott. Mr. Adams served as Vice Chairman from 2011 to 2013 and served as Chairman from 2013 to 2015. He is the Chairman of the Committee on Audit and serves as a member of the Committee on Buildings and Physical Plant. He has served as Chairman of the Committee on Finance, and the Committee on Buildings and Physical Plant. His term expires February 1, 2021.



**Robert L. Albritton** was appointed to the Board of Regents by Governor Abbott in 2015. He currently serves as Chairman of the Committee on Finance, as a member of the Committee on Academic and Student Affairs, and as a liaison to the Development Foundations of A&M System Members. He has served as a member of the Committee on Audit, the Committee on Buildings and Physical Plant, and as a liaison to the Texas A&M University Corps of Cadets and System Military Training Programs. His term expires February 1, 2021.



**Jay C. Graham** was appointed as a member of the Board of Regents by Governor Abbott in 2019. He serves as a member of the Committee on Finance and the Committee on Academic and Student Affairs. Mr. Graham also serves on the University Lands Advisory Board, and as a liaison to the 12th Man Foundation. His term expires February 1, 2025.



**Michael A. "Mike" Hernandez III** was appointed as a member of the Board of Regents by Governor Abbott in 2019. He serves as a member of the Committee on Audit and the Committee on Academic and Student Affairs. He also serves on the Board for Lease of University Lands. His term expires February 1, 2025.



**William "Bill" Mahomes** was appointed to the Board of Regents by Governor Abbott in 2015. He currently serves as the Chairman of the Committee on Buildings and Physical Plant and as a member of the Committee on Audit. He has served as Chairman of the Committee on Finance and as a member of the Committee on Academic and Student Affairs. He also serves as a liaison to the Texas A&M University Corps of Cadets and System Military Training Programs. He has served as a liaison to the Development Foundations of A&M System Members. His term will expire February 1, 2021.



**Michael J. Plank** was appointed as a member of the Board of Regents by Governor Abbott in 2019. He serves as a member of the Committee on Audit and the Committee on Buildings and Physical Plant. He also serves as a liaison to the Texas A&M University Corps of Cadets and System Military Training Programs. His term expires February 1, 2025.



**Cliff Thomas** was appointed to the Board of Regents by Governor Perry in 2011 and reappointed in 2017 by Governor Abbott. He served as Vice Chairman from 2013-2015 and as Chairman from 2015-2017. Mr. Thomas is the Chairman of the Committee on Academic and Student Affairs and a member of the Committee on Finance. He has served as Chairman of the Committee on Audit and the Policy Review Committee, and as a member of the Committee on Buildings and Physical Plant. Mr. Thomas chaired the search committee in 2014-2015 for the new President of Texas A&M University. His term expires February 1, 2023.



**Cahlen Cheatham** is a first-generation college student and double major pursuing a Bachelor of Science degree in Agribusiness and Economics at Tarleton State University in Stephenville. As a freshman, he was elected president of the largest collegiate FFA chapter in the nation and was selected by faculty to found the College of Agricultural and Environmental Sciences (COAES) Leadership Council. He was elected President of the Leadership Council by his peers for two terms and was selected to join the COAES Ambassadors. With a record number of votes in the March election, he was elected to serve as the first Division I Student Body President of Tarleton. His term expires on May 31, 2021.

## Chancellor



**John Sharp** was appointed Chancellor of The Texas A&M University System by the Board of Regents on September 6, 2011. As Chancellor of the A&M System, he leads one of the nation's largest university systems, including 11 universities and eight state agencies, which has an annual budget of \$6.3 billion. Enrollment at the A&M System's 11 universities has grown to more than 152,000 and externally funded research expenditures are in excess of \$1 billion. Chancellor Sharp brings with him more than three decades of public service and a passion to make the A&M System the best system of higher education in the country.

[chancellor.tamus.edu](http://chancellor.tamus.edu)



# Frequently Asked Questions

## What is The Texas A&M University System?

The A&M System is one of the largest systems of higher education in the nation, with a statewide network of 11 universities and eight state agencies. A&M System universities educate more than 152,000 students and reach another 24 million people through service each year. With more than 26,000 faculty and staff, the A&M System has a physical presence in 250 of the state's 254 counties and a programmatic presence in every one. System-wide, externally funded research expenditures exceed \$1 billion to help drive the state's economy.

## When was the A&M System established?

The A&M System was officially established in 1948. The original members were Texas A&M University, Prairie View A&M University, Tarleton State University, Texas A&M Forest Service, Texas A&M Engineering Experiment Station, Texas A&M Engineering Extension Service, Texas A&M AgriLife Extension Service (formerly Texas Cooperative Extension) and Texas A&M AgriLife Research (formerly Texas Agricultural Experiment Station).

Today, the A&M System provides oversight and leadership for 11 universities and eight state agencies. Its role is governed by the state's education code (Title 3, chiefly Ch. 51, Sec. 51.353 and Ch. 85, Sec. 85.17). Responsibilities include system-wide planning, coordination and execution of the policies of The Texas A&M University System Board of Regents.

## What does “A” and “M” stand for?

Texas A&M University, the state's first public institution of higher education, was opened on Oct. 4, 1876 as the Agricultural and Mechanical College of Texas. Both Texas A&M and Prairie View A&M owe their origin to the Morrill Acts of 1862 and 1890, which established the nation's land-grant college system. When Texas A&M gained university status in 1963, the “A&M” was incorporated into the official name in deference to the institution's history and traditions, but the individual letters no longer explicitly stand for anything.

## The A&M System is the state’s land-grant system. What does that mean?

A land-grant college or university is an institution that has been designated by its state legislature or Congress to receive the benefits of the Morrill Acts of 1862 and 1890. The original mission of these institutions, as set forth in the first Morrill Act, was to teach agriculture, military tactics and the mechanical arts, as well as classical studies so that members of the working classes could obtain a practical education.

The A&M System's agencies, which conduct research and bring practical applications of research findings to the people of Texas, also came out of the land-grant system. There is now at least one land-grant institution in every state and territory of the United States, as well as in the District of Columbia.

## How is the A&M System governed?

The A&M System is governed by a nine-member Board of Regents, appointed by the governor and confirmed by the Texas Senate for six-year terms. A nonvoting student member was added in 2006. The A&M System chancellor oversees the day-to-day administration, and each of the A&M System's members has a president, CEO or director.

## What is the mission of the A&M System?

The mission of the A&M System is to provide education, conduct research, commercialize technology, offer training and deliver services for the people of Texas and beyond through its universities and state agencies.

## Does the A&M System have a central admissions office?

No. Students must contact directly the preferred A&M System institution's admission office. Information about these institutions can be found on the system's website, [tamus.edu](https://www.tamus.edu).

## Faculty, Staff and Student Headcount

Fall 2020	Faculty	Staff	Student Enrollment
ACADEMIC INSTITUTIONS			
Texas A&M University <sup>1</sup>	3,825	7,266	68,356
Texas A&M University at Galveston	124	176	1,653
Texas A&M University at Qatar	76	222	707
Texas A&M University Higher Education Center at McAllen <sup>2</sup>	18	33	242
Prairie View A&M University	546	752	9,248
Tarleton State University	695	590	14,022
Texas A&M International University	403	422	8,270
Texas A&M University-Corpus Christi	675	850	10,820
Texas A&M University-Kingsville	429	543	6,915
West Texas A&M University	435	491	10,051
Texas A&M University-Commerce	694	567	11,624
Texas A&M University-Texarkana	172	165	2,161
Texas A&M University-Central Texas	188	156	1,808
Texas A&M University-San Antonio	367	355	6,741
RELLIS <sup>2</sup>	47	20	380
<b>Subtotal - General Academic</b>	<b>8,629</b>	<b>12,555</b>	<b>152,376</b>

<sup>1</sup> includes TAMHSC and McAllen

<sup>2</sup> faculty, staff and student numbers are included in home institution numbers

## AGENCIES

System Offices		285	
Texas A&M AgriLife Research	165	1,380	
Texas A&M AgriLife Extension Service	98	1,359	
Texas A&M Forest Service		502	
Texas A&M Veterinary Medical Diagnostic Laboratory		161	
Texas A&M Engineering Experiment Station		506	
Texas A&M Engineering Extension Service <sup>3</sup>		476	178,063
Texas A&M Transportation Institute		381	
The Texas Division of Emergency Management		264	
<b>Subtotal - Agencies</b>	<b>263</b>	<b>5,314</b>	<b>178,063</b>
<b>Total - A&amp;M System</b>	<b>8,892</b>	<b>17,869</b>	<b>330,439</b>

<sup>3</sup> student number is per year

## Student Diversity

Fall 2020

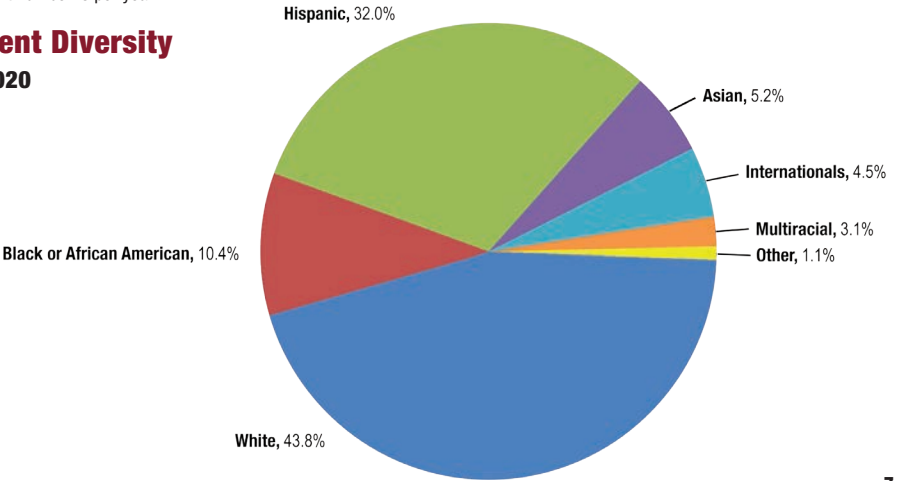



THE RELIS CAMPUS

A&M System Member Research Expenditures

Texas A&M University and Brazos County agencies	\$952,156,000
Prairie View A&M University	\$18,018,000
Tarleton State University	\$13,171,000
Texas A&M International University	\$6,068,000
Texas A&M University-Corpus Christi	\$32,944,000
Texas A&M University-Kingsville	\$22,268,000
West Texas A&M University	\$5,437,000
Texas A&M University-Commerce	\$3,403,000
Texas A&M University-Texarkana	\$6,000
Texas A&M University-Central Texas	\$889,000
Texas A&M University-San Antonio	\$308,000
<b>Total - A&amp;M System</b>	<b>\$1,054,668,000</b>

Source: National Science Foundation

Research Funding Sources

2019 Total \$1,054,668,000

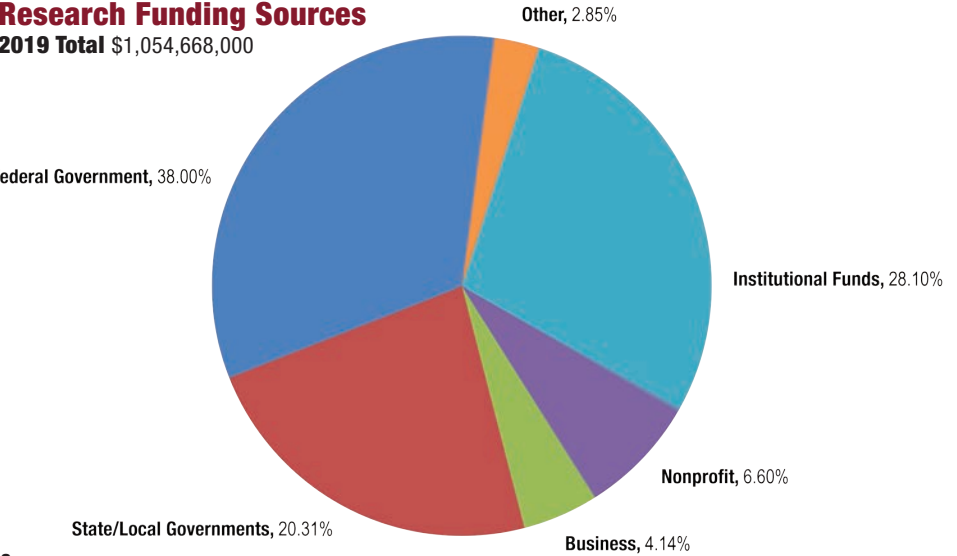

Average Tuition and Fees

Texas A&M University	\$10,849
Texas A&M University at Galveston	\$12,128
Prairie View A&M University	\$11,067
Tarleton State University	\$9,528
Texas A&M International University	\$9,254
Texas A&M University-Corpus Christi	\$10,316
Texas A&M University-Kingsville	\$9,689
West Texas A&M University	\$9,014
Texas A&M University-Commerce	\$9,820
Texas A&M University-Texarkana	\$8,510
Texas A&M University-Central Texas	\$6,868
Texas A&M University-San Antonio	\$8,907

Source: Texas Higher Education Accountability System

\*Tuition and Fees is defined as the average cost of mandatory tuition and fees charged a student taking 30 semester credit hours

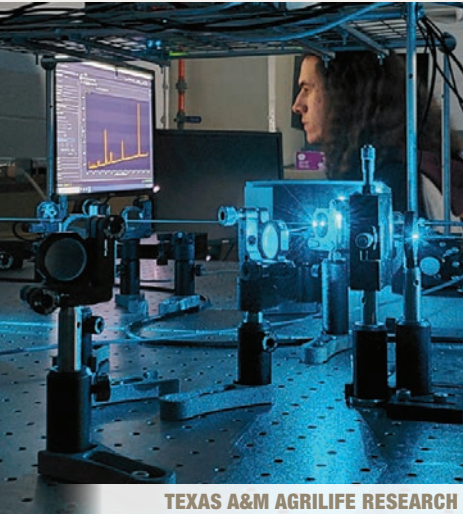

TEXAS A&M AGRILIFE RESEARCH



TEXAS A&M UNIVERSITY-SAN ANTONIO



TEXAS A&M UNIVERSITY-CORPUS CHRISTI

Technology Transfer

New Invention Disclosures	356
Patents Filed - U.S. & Foreign	228
U.S. Patents Issued	60
License Agreements	41
Start-Up Companies Formed	8
License Revenue	\$8,017,845



# Memorable Moments From 2020



**Texas A&M System  
Invests Half-Billion  
Dollars in Texas Medical  
Center**

**COVID-19 Changes  
Operations Across the  
Texas A&M System**



**Texas A&M System  
Hosts July 4th Drive-In  
Fireworks at RELLIS**

**Feds Tap Bio-  
Manufacturing Center in  
College Station for “Warp  
Speed” Production of  
COVID-19 Vaccines**



**Texas A&M Maritime  
Academy Stands Ready  
to Accept New 525-Foot  
Training Ship**

**Defense Department Taps  
Texas A&M System to  
Lead U.S. Consortium on  
Advancing Hypersonic  
Flight Systems**



[tamu.edu](https://tamu.edu)

@tamu /tamu tamu Texas A&M University u/tamu

ESTABLISHED ..... 1876  
COLORS ..... Maroon and white  
NICKNAME ..... Aggies  
ATHLETIC AFFILIATION ..... Southeastern Conference (SEC)



The flagship university of The Texas A&M University System, **TEXAS A&M UNIVERSITY** is known around the world as a tier one research institution and is a member of the Association of American Universities.

Committed to the values of its land-grant heritage, Texas A&M ensures accessible education for the people of Texas and beyond through effective resource management, maintaining low costs for high-value curricular and co-curricular excellence and graduating students with less debt. World-class faculty members engage our teaching and research, which inform innovation for society’s challenges, yielding over \$952 million in annual expenditures. Knowledge extends to communities beyond the classroom by engaged scholarship, outreach and partnership with System state agencies for extension. These efforts have also earned Texas A&M designations as a sea-grant and space-grant institution.

Texas’ first public institution of higher learning has strategically grown into one of the nation’s most comprehensive universities, offering over 400 bachelor’s, master’s, doctoral and professional degree programs through 17 colleges and schools, including the School of Law in Ft. Worth, and the health-related programs of the Health Science Center. Together with special-purpose branch campuses in Galveston and Qatar, along with an educational site in McAllen, today’s Texas A&M is developing educated leaders of character committed to learning for a lifetime and dedicated to serving the greater good.





**TEXAS A&M UNIVERSITY AT GALVESTON** is an ocean-oriented branch campus of Texas A&M University which educates nearly 2,300 undergraduate and graduate students in a unique blend of marine and maritime programs, including majors in science, business, engineering, liberal arts, and transportation. It serves a critical role in fulfilling the sea-grant portion of Texas A&M's land-, sea-, space-grant mission and has nearly \$10 million annually in research expenditures. Texas A&M-Galveston is also home to the Texas A&M Maritime Academy, one of seven in the U.S. and the only academy integrated into a Tier 1 academic institution, which trains over 300 cadets annually for maritime service and employment around the world. Texas A&M-Galveston is located on the Gulf Coast, where it is surrounded by the industry, environment and programs essential to fulfilling its special-purpose mission.



[tamug.edu](http://tamug.edu)

[f](#) [t](#) [i](#) [@](#)AggiesbytheSea

TEXAS A&M UNIVERSITY AT GALVESTON  
PO Box 1675, Galveston, TX 77553 | 877-322-4443



جامعة تكساس إي أند أم في قطر



**TEXAS A&M UNIVERSITY AT QATAR** has offered undergraduate degrees in chemical engineering, electrical and computer engineering, mechanical engineering and petroleum engineering at Qatar Foundation's Education City campus since 2003, and graduate degrees in chemical engineering since fall 2011. More than 1,170 degrees have been awarded since 2007. All four of the undergraduate engineering programs offered at Texas A&M at Qatar are accredited by the Engineering Accreditation Commission of ABET, [www.abet.org](http://www.abet.org). Faculty members from around the world are attracted to Texas A&M at Qatar to provide this educational experience and to participate in research activities now valued at more than \$263.9 million. Texas A&M at Qatar is wholly funded by the Qatar Foundation for Education, Science and Community Development.

[www.qatar.tamu.edu](http://www.qatar.tamu.edu)

[f](#) [t](#) [i](#) [@](#)tamuq [t](#) tam

TEXAS A&M UNIVERSITY AT QATAR  
PO Box 23874, Doha, Qatar | +974-4423-0201



**TEXAS A&M UNIVERSITY HEALTH SCIENCE CENTER** (Texas A&M Health) comprises five colleges (dentistry, medicine, nursing, pharmacy and public health) and numerous centers and institutes with a shared mission of advancing health care for all. We serve the state and beyond with campuses and locations in Bryan-College Station, Dallas, Temple, Houston, Round Rock, Kingsville, Corpus Christi and McAllen. Drawing from our vast network of scientists, educators and clinical partners, Texas A&M Health provides real-world solutions through evidence-based discoveries and highly qualified graduates who are equipped to address the health needs of an ever-changing population.

[health.tamu.edu](http://health.tamu.edu)

[f](#) [t](#) [i](#) [@](#)TAMUHealth  
[in](#) Texas A&M Health Science Center

TEXAS A&M UNIVERSITY HEALTH SCIENCE CENTER  
8441 Riverside Pkwy, Bryan, TX 77807 | 979-436-9100



In one the nation's most unique community partnerships, Texas A&M University, the City of McAllen and Hidalgo County have combined resources to extend existing degree programs in fields of high demand to the Rio Grande Valley. The **TEXAS A&M UNIVERSITY HIGHER EDUCATION CENTER AT MCALLEN**, currently offers seven distinct bachelor degrees in fields identified by local industry leaders: agricultural economics, biomedical science, construction science, interdisciplinary engineering, multidisciplinary engineering technology, public health and university studies in arts and sciences. With courses taught by accredited Texas A&M University faculty, students are eligible to earn the Aggie Ring and diploma from one of the world's leading universities while also benefitting from the financial advantages of living close to home and maintaining access to unique career opportunities in the Rio Grande Valley.



[mcallen.tamu.edu](http://mcallen.tamu.edu)

[f](#) [t](#) [i](#) [@](#)tamumcallen

TEXAS A&M HIGHER EDUCATION CENTER AT MCALLEN  
6200 Tres Lagos Blvd., McAllen, TX 78504 | 956-271-1300





ESTABLISHED .....1876  
 JOINED A&M SYSTEM.....1876  
 COLORS .....Royal purple and gold  
 NICKNAME.....Panthers  
 ATHLETIC AFFILIATION.....Southwestern  
 Athletic Conference



tarleton.edu



ESTABLISHED .....1899  
 JOINED A&M SYSTEM.....1917  
 COLORS .....Purple and white  
 NICKNAME.....Texans  
 ATHLETIC AFFILIATION.....Lone Star Conference



**PRAIRIE VIEW A&M UNIVERSITY** is the second oldest public institution of higher education in the state of Texas. It is a historically black college/university that, since its inception in 1876, has opened its doors to any and every person – inside and outside of Texas – seeking a first-class, four-year university experience. The university has over 50 buildings on 1440- acres and is situated in a rural part of Texas on one of the most beautiful campuses in the country.

Mentioned in the Texas State Constitution as an “institution of the first class,” PVAMU began as an industrial school for African Americans but has evolved to meet changing societal demands. Through its nine colleges and schools, PVAMU boasts more than 70 degree programs,



including engineering, natural sciences, business, nursing, and criminal and juvenile justice. PVAMU's enrollment now exceeds 8,000, including more than 2,000 graduate students. To date, some 76,000 academic degrees have been awarded.

Next year, construction is expected to begin on a \$70 million Engineering Classroom and Research Building. Lab spaces will be designed to support 3D manufacturing, space exploration, data analytics and artificial intelligence, robotics, structural analysis, and more.

PRAIRIE VIEW A&M UNIVERSITY

FM 1098 Road and University Drive, Prairie View, TX 77446 | 936-261-3311

Providing an innovative and transformative educational experience, **TARLETON STATE UNIVERSITY**, offers 74 undergraduate, 30 graduate and two doctorate degree options and serves more than 14,000 students. Tarleton boasts four schools — the School of Nursing, the School of Engineering, the School of Kinesiology and the School of Criminology, Criminal Justice and Strategic Studies. And six colleges — Agricultural and Environmental Sciences, Business, Education, Health Sciences and Human Services, Liberal and Fine Arts, and Science and Technology.

Creation of a new Leadership and Military College in 2020 resulted from the rapid growth of the Texan Corps of Cadets since its reinstatement in 2016.

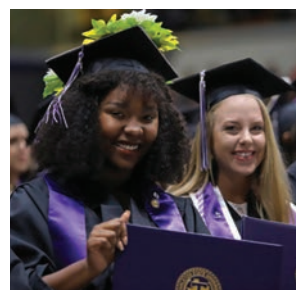

Tarleton's move to NCAA Division I as a member of the Western Athletic Conference and the announcement of a second building on the Fort Worth campus are positioning the institution as a front-runner for anyone seeking a university education.

Additionally, plans are underway for the Center for Rural Research, Innovation and Economic Development, moving Tarleton closer to becoming the premier comprehensive regional university in the nation. The center will strengthen faculty-led student research and spur regional growth and job creation.

TARLETON STATE UNIVERSITY

1333 West Washington, Stephenville, TX 76402 | 254-968-9000





TEXAS A&M  
INTERNATIONAL  
UNIVERSITY

tamiu.edu



ESTABLISHED .....1970  
JOINED A&M SYSTEM.....1989  
COLORS .....Maroon and silver  
NICKNAME..... Dustdevils  
ATHLETIC AFFILIATION..... Lone Star Conference

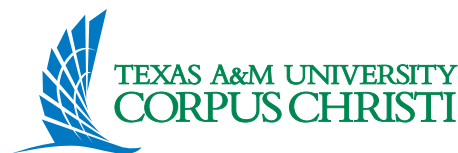
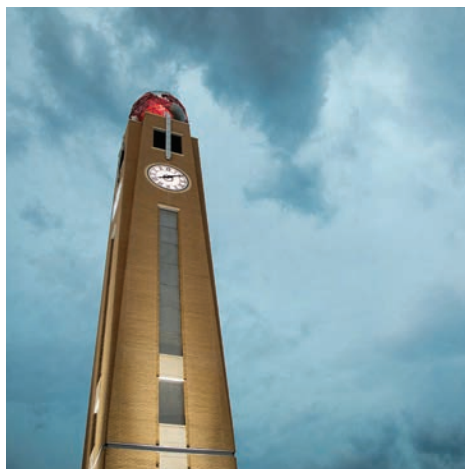

tamucc.edu



ESTABLISHED .....1947  
JOINED A&M SYSTEM.....1989  
COLORS .....Blue and green  
NICKNAME..... Islanders  
ATHLETIC AFFILIATION..... Southland Conference



**TEXAS A&M INTERNATIONAL UNIVERSITY** is a vibrant international university located at the dynamic multicultural and multilingual crossroads that is Laredo.

It provides over 8,200 students with a transformative learning environment anchored by the highest quality programs delivered by a global faculty. A solid academic foundation in the arts and sciences, business, education and nursing embraces broad research opportunities. The 300-acre campus is home to a diverse student body with 122 student clubs and organizations driving an energetic campus life. Service-learning fuels dynamic community involvement and study abroad programs travel to 50-plus countries.

TAMIU celebrated its 50th Anniversary of founding and its 25th Anniversary at its north Laredo campus in 2020. Like its enrollment, its growth continues with the addition of its largest classroom building, the Academic Innovation Center, home to dynamic engineering and science programs.

TAMIU's programs are infused with an international focus and a progressive agenda for global study, leadership and understanding across all disciplines.



**TEXAS A&M UNIVERSITY-CORPUS CHRISTI**, established in 1947, has more than 50,000 graduates including nurses, educators, researchers, artists, scientists and innovators who are passionate about leading in their professions.

Our status as a tier two (R2) research institution reflects our ability to serve as an ecosystem for innovation and intellectual hub for the Texas Coastal Bend and beyond. With an unparalleled commitment to every student's success, the Island University supports more than 40 scientific research centers and labs. Lone Star Center of Excellence and Innovation is one of only seven unmanned aircraft system test sites in the U.S. and works with NASA to advance the field. The Harte Research

Institute for Gulf of Mexico Studies leads international research efforts for the long-term sustainable use and conservation of the Gulf of Mexico. The Conrad Blucher Institute for Surveying and Science is nationally-recognized for developing innovative geospatial science research with real-world impact. Texas A&M-Corpus Christi is the only university in the nation located on its own island and is a learning destination like no other. We're proud of our heritage as a Hispanic-Serving Institution and offer myriad opportunities for students to make an impact in the community.





tamuk.edu

@javelinas @JavelinaNation  
TAMUKJavelinaPride

ESTABLISHED ..... 1925  
JOINED A&M SYSTEM..... 1989  
COLORS ..... Blue and gold  
NICKNAME ..... Javelinas  
ATHLETIC AFFILIATION ..... Lone Star Conference



wtamu.edu

@wtamu

ESTABLISHED ..... 1910  
JOINED A&M SYSTEM..... 1990  
COLORS ..... Maroon and white  
NICKNAME ..... Buffaloes (Bufs and Lady Bufs)  
ATHLETIC AFFILIATION ..... Lone Star Conference



For 95 years, **TEXAS A&M UNIVERSITY-KINGSVILLE** has represented excellence and innovation, while preparing students to become the leaders of tomorrow.

The university offers a complete college experience on a beautiful and vibrant campus with a variety of undergraduate and graduate programs developed to meet the growing economic needs of Texas and beyond. Degrees include well-known programs in environmental engineering, animal and wildlife sciences, music and natural gas engineering, along with new or growing programs in veterinary technology, kinesiology and social work. A Carnegie-recognized

Doctoral University with High Research Activity, Texas A&M-Kingsville features nationally and internationally recognized research centers, including the National Natural Toxins Research Center, the Caesar Kleberg Wildlife Research Institute and the King Ranch Institute for Ranch Management. Helpful staff and faculty committed to students' success create a sense of community that extends beyond the campus. Forbes Media placed Texas A&M-Kingsville 21st in the Top 25 universities in the nation based on alumni ratings. The university offers an all-inclusive environment with a variety of living and dining options and recreational activities within walking distance of the classroom. The campus features an all-inclusive environment with a variety of dining options, a student recreation center and suite-style residence halls within walking distance of the classroom.

TEXAS A&M UNIVERSITY-KINGSVILLE

700 University Boulevard, Kingsville, TX 78363 | 361-593-2111



For 110 years, **WEST TEXAS A&M UNIVERSITY** has attracted bright minds from the Panhandle and the world with superior academics, renowned faculty and affordable tuition.

WTAMU is a four-year public university that serves a diverse student population of more than 10,000 students, offering 60 undergraduate programs, 38 graduate programs and two doctoral degree programs. WT students are guaranteed an exceptional educational experience in high-demand fields — accounting, business, education, nursing and much more. Students learn from top faculty in smart classrooms in multiple locations, including the Canyon campus and the Harrington

Academic Hall WATMU Amarillo Center. Courses are also offered in partnership with the Texas A&M College of Veterinary Medicine & Biomedical Sciences at the new Veterinary Education, Research, & Outreach and Charles W. Graham, DVM Texas Veterinary Medical Diagnostic Laboratory buildings. University initiatives facilitate research opportunities, internships, leadership development programs and network-building interactions between students and professionals in their fields of study. With its award-winning academic programs, athletic conference and national championships, and state-of-the-art facilities, WTAMU is a growing, vibrant university that is well-prepared to meet the educational needs of students in a rapidly changing world. New World. New Way. Always WT.

WEST TEXAS A&M UNIVERSITY

2501 4th Avenue, Canyon, TX 79016 | 806-651-0000





tamuc.edu

@tamuc @tamuc @tamuc lionsmedia

ESTABLISHED ..... 1889  
JOINED A&M SYSTEM ..... 1996  
COLORS ..... Blue and gold  
NICKNAME ..... Lions  
ATHLETIC AFFILIATION ... Lone Star Conference



tamut.edu

@tamut @TAMUTexarkana  
 @tamutexarkana pinterest.com/tamut

ESTABLISHED ..... 1971  
JOINED A&M SYSTEM ..... 1996  
COLORS ..... Blue, gold and maroon  
NICKNAME ..... Eagles  
ATHLETIC AFFILIATION ..... National Association of Intercollegiate Athletics



**TEXAS A&M UNIVERSITY-COMMERCE** provides quality education with world-class professors who dedicate themselves to excellence in teaching and research to an inclusive community of diverse learners.

One of the most affordable universities in East Texas, A&M-Commerce offers more than 130 degrees at seven Texas locations. The university maintains strong relationships with local industries to create relevant academic programs and valuable internship and networking opportunities that prepare career-ready graduates.

A leader in competency-based education, A&M-Commerce is the nation's first institution to offer an accredited competency-based bachelor's

degree in criminal justice. The agriculture program is also a national stand-out, featuring one of the only programs where students grow experimental crops on the university's 1,500-acre farm. In addition, A&M-Commerce upholds a 130-year legacy as an exceptional teachers' college, graduating more than 400 certified educators in 2019.

In 2020, the university opened the 113,470-square-foot Nursing and Health Sciences Building, featuring a state-of-the-art simulation hospital, designed to help address the dire shortage of healthcare professionals in Texas.

TEXAS A&M UNIVERSITY-COMMERCE

2600 South Neal Street, Commerce, TX 75429 | 903-886-5000



**TEXAS A&M UNIVERSITY-TEXARKANA** is uniquely positioned to serve a four-state area, contributing to the region's dynamic and diverse culture and resources. Set in the beautiful forest and lake-filled corner of northeast Texas, A&M-Texarkana is a university where you can get a world-class education in a nurturing, student-oriented environment. This year marks TAMUT's 50th year as an institution and 25 years as a member of the Texas A&M University System. The university stands ready to provide the area with highly qualified graduates who meet the needs of employers throughout the region well into the future. The university offers a wide array of degree programs, including the new Psychiatric Mental Health Nurse Practitioner program launching in the fall of 2021.

Set on a breathtaking 375-acre campus, students at TAMUT have all they need to live, learn and experience the very best of college life. Small class sizes and dedicated faculty and staff help facilitate the university's close-knit, family-like university community. With more than 40 student groups (including Greek life), eight intercollegiate sports, social activities and intramurals, students can explore TAMUT outside the classroom and make connections that last a lifetime.

TEXAS A&M UNIVERSITY-TEXARKANA

7101 University Avenue, Texarkana, TX 75503 | 903-223-3000





TEXAS A&M  
UNIVERSITY  
CENTRAL TEXAS

tamuct.edu

f t i @tamuct

ESTABLISHED AS SYSTEM CENTER..... 1999

ESTABLISHED AS STAND-ALONE  
UNIVERSITY..... 2009

COLORS ..... Navy, maroon and silver

NICKNAME..... Warriors



TEXAS A&M UNIVERSITY  
SAN ANTONIO

tamusa.edu

f t i @TAMUSanAntonio tamusavids  
in Texas A&M University-San Antonio tamu-sa

ESTABLISHED AS SYSTEM CENTER.....2000

ESTABLISHED AS STAND-ALONE  
UNIVERSITY.....2009

COLORS ..... Black, silver and "Madla Maroon"

NICKNAME..... Jaguars



TEXAS A&M UNIVERSITY-CENTRAL TEXAS is the only public "upper-level" university in Texas, offering upper-division coursework leading to baccalaureate degrees, and graduate coursework leading to master's degrees.

The only public university in Texas that exclusively recruits and serves transfer students at the baccalaureate level, A&M-Central Texas is an exceptional option for community college students, as well as those individuals with some college but no degree. At A&M-Central Texas, undergraduate students may select from 28 baccalaureate and 18 graduate degree programs. As one of the most affordable public universities in Texas, A&M-Central Texas offers its students an

innovative array of financial assistance, a 12 SCH maximum for tuition regardless of the number of hours taken, and an option to guarantee that tuition and fees will not change for up to 3 years.

Degree programs at A&M-Central Texas are offered through three Colleges, including Arts and Sciences, Business Administration and Education and Human Development. Programs are designed to provide personalized learning experiences whether delivered on-campus, online, or through innovative hybrid modalities. With the conclusion of the 2020 Fall Term, A&M-Central Texas will have produced more than 8,000 graduates prepared to serve the region, the state, and the nation.

TEXAS A&M UNIVERSITY-CENTRAL TEXAS  
1001 Leadership Place, Killeen, TX 76549 | 254-519-5400



TEXAS A&M UNIVERSITY-SAN ANTONIO is a comprehensive four-year university offering more than 40 undergraduate and graduate programs to almost 6,800 students.

A&M-San Antonio is situated on nearly 700 acres in south San Antonio and reflects the culturally diverse, heritage-rich community it serves, offering the lowest undergraduate tuition of any four-year university in San Antonio.

Established as a stand-alone university in 2009, it is home to the Henry G. Cisneros Institute for Emerging Leaders and the Cyber Engineering Technology/Cyber Security Research Center. It proudly became the ninth

university in the country, and the first in Texas, to join the Facebook Cyber Security University Program.

The university holds the Hispanic-Serving Institution (HSI) designation and Military Times ranks the University No. 35 in the nation for "Best for Vets: Colleges."

The university's core values provide a foundation for its world-class faculty to prepare graduates for rewarding careers, responsible global citizenship and lifelong learning.

TEXAS A&M UNIVERSITY-SAN ANTONIO  
One University Way, San Antonio, TX 78224 | 210-784-1000



rellis.tamus.edu/academicalliance



ESTABLISHED ..... 2016  
FIRST ACADEMIC CLASS..... Fall 2018  
ACADEMIC PARTNERS..... 12  
BACHELOR'S DEGREES OFFERED..... 25  
EDUCATIONAL SPACE ..... 113,000 SQFT  
STUDENT-FACULTY RATIO .....13:1

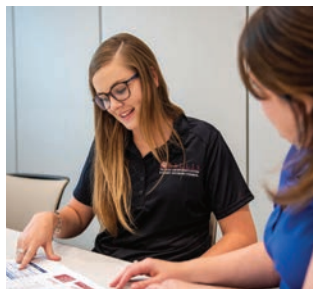

The **RELLIS CAMPUS** in Bryan is home to the only academic alliance in the nation that combines a major university system and a community college in one location. Designed to provide a seamless educational experience, students can take freshman- and sophomore-level courses with the Blinn College District before transferring to a Texas A&M System regional university to earn a bachelor's degree.

The state-of-the-art campus features the 83,000 square-foot Blinn College Walter C. Schwartz building and the Texas A&M System Academic Complex. Opened in August 2019, the Academic Complex is home to A&M System regional university degree offerings and accommodates approximately 2,500 students. The 67,000 square-foot-building includes faculty offices, 10 classrooms, group learning and collaborative spaces, modern allied health teaching laboratories and upper-division science laboratories.

Opening in January 2021, the second building in the RELLIS Academic Complex will include classrooms and laboratories incorporating innovative teaching and technology, as well as faculty offices and spaces for student collaboration. Most notably, the building will provide the needed space for engineering labs and classrooms to facilitate upcoming academic engineering program offerings.

**RELLIS ACADEMIC ALLIANCE**  
3100 TX-47, Bryan, TX 77807 | 979-317-3400



**TDEM**  
THE TEXAS A&M UNIVERSITY SYSTEM

TDEM.texas.gov



ESTABLISHED .....1951  
JOINED A&M SYSTEM.....September 1, 2019  
FY 2020 FEDERAL FUNDS MANAGED ..... \$9.2B  
FY 2020 FEDERALLY DECLARED DISASTERS  
IN TX..... 3  
FEDERALLY DECLARED DISASTERS SINCE  
1953.....100



The **TEXAS DIVISION OF EMERGENCY MANAGEMENT** (TDEM) manages the state's emergency management program. Texas receives more federal disaster declarations than any other state in the nation, an average of one every eight months. TDEM supports local jurisdictions by partnering with state and federal agencies to ensure Texas prepares for, responds to, recovers from, mitigates against and becomes more resilient for future disasters.

TDEM manages a full spectrum of emergency management programs including preparedness, response, recovery and mitigation. Preparedness programs provide support for planning, training and exercises while field staff supports local jurisdictions across the state. Recovery and Mitigation manage billions of dollars in FEMA grant funds as they assist local jurisdictions in recovering from disasters.

As a result of Hurricane Harvey and the Commission to Rebuild Texas, many improvements to the way Texas prepares for, responds to, recovers from, and mitigates against major disasters have been set in motion, including the merger between Texas emergency management and institutions of higher education. With this merger, the state capitalizes on synergies between the capabilities of higher education and research and the actions of emergency management, thus improving life safety, the protection of property and leading to quicker recovery from disasters.

**TEXAS DIVISION OF EMERGENCY MANAGEMENT**  
1033 La Posada Drive, Suite 370, Austin, Texas 78752-3832 | 512-424-2208



# TEXAS A&M AGRILIFE RESEARCH

agriliferesearch.tamu.edu

@txresearch

ESTABLISHED .....1888  
NUMBER OF RESEARCH PROJECTS.....637  
FY 2018 RESEARCH FUNDING .....\$217.3M  
NUMBER OF CENTERS OR DIVISIONS..... 13  
DOCTORAL-LEVEL SCIENTISTS..... 400+

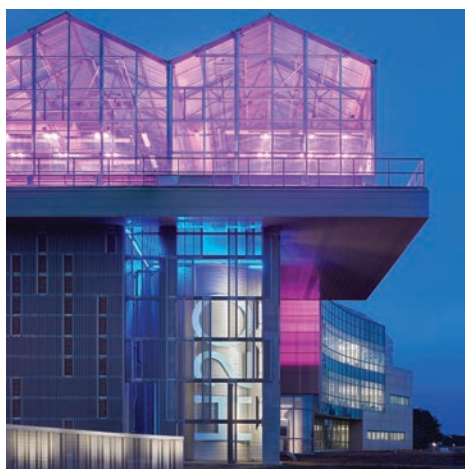

# TEXAS A&M AGRILIFE EXTENSION

agrilifeextension.tamu.edu

@agrilifeextension @txextension  
txextension Texas A&M AgriLife Extension

ESTABLISHED .....1915  
NUMBER OF TEXAS COUNTIES SERVED.....254  
NUMBER OF VOLUNTEERS SUPPORTING  
EXTENSION PROGRAMS..... 93,000+  
ENGAGEMENT IN 4-H AND YOUTH  
DEVELOPMENT PROGRAMS.....557,000 youth



TEXAS A&M AGRILIFE RESEARCH is the state and nation's premier research and development agency for agriculture, natural resources and the life sciences. With a statewide presence – from our headquarters in College Station, to other Texas A&M University System campuses and 13 regional Research and Extension Centers – we provide innovative solutions to 21st-century challenges.

Our research helps enhance competition and prosperity in agriculture, sustain healthy ecosystems and conserve natural resources, improve public health and create resilient communities, and optimize plant and animal production. In fact, we are ranked second nationally for agricultural research expenditures by the National Science Foundation.

AgriLife Research conducts research in the Texas A&M Colleges of Agriculture and Life Sciences and Veterinary Medicine and Biomedical Sciences and collaborates with nine other A&M System centers and institutes, as well as with state and federal agencies, private-sector corporations and international scientists.



The TEXAS A&M AGRILIFE EXTENSION SERVICE is a unique education agency that provides programs, tools and resources on a local and statewide level that teach people how to improve agriculture and food production, advance health practices, protect the environment, strengthen the economy and enrich youth.

Through a statewide network of professional educators, trained volunteers and county offices, AgriLife Extension addresses the diverse range of contemporary and emerging issues that affect local communities. With 250 county offices serving Texans in all 254 counties, County Extension Agents serve families, youth, communities and businesses throughout the state. The agency also

provides natural disaster assistance.

Whether leading diabetes education programs, giving demonstrations on passenger safety, conducting agriculture field days, offering web-based classes for child care licensing or answering questions one-on-one about soil testing, AgriLife Extension provides relevant continuing education that encourages lasting and effective change.

We improve lives, the environment and the Texas economy through extension education and service.

TEXAS A&M AGRILIFE RESEARCH

600 John Kimbrough Boulevard, Suite 512 | 2142 TAMU, College Station, TX 77843 | 979-845-8486

TEXAS A&M AGRILIFE EXTENSION SERVICE

600 John Kimbrough Boulevard, Suite 509 | 7101 TAMU, College Station, TX 77843-7101 | 979-845-7800 27





tfsweb.tamu.edu

@TexasForestService

@TXForestService

ESTABLISHED .....1915

NUMBER OF TEXAS COUNTIES SERVED .....254



tvmdl.tamu.edu

@tvmdl

ESTABLISHED .....1967

ANNUAL CASELOAD .....166,000

NUMBER OF LABORATORIES .....4

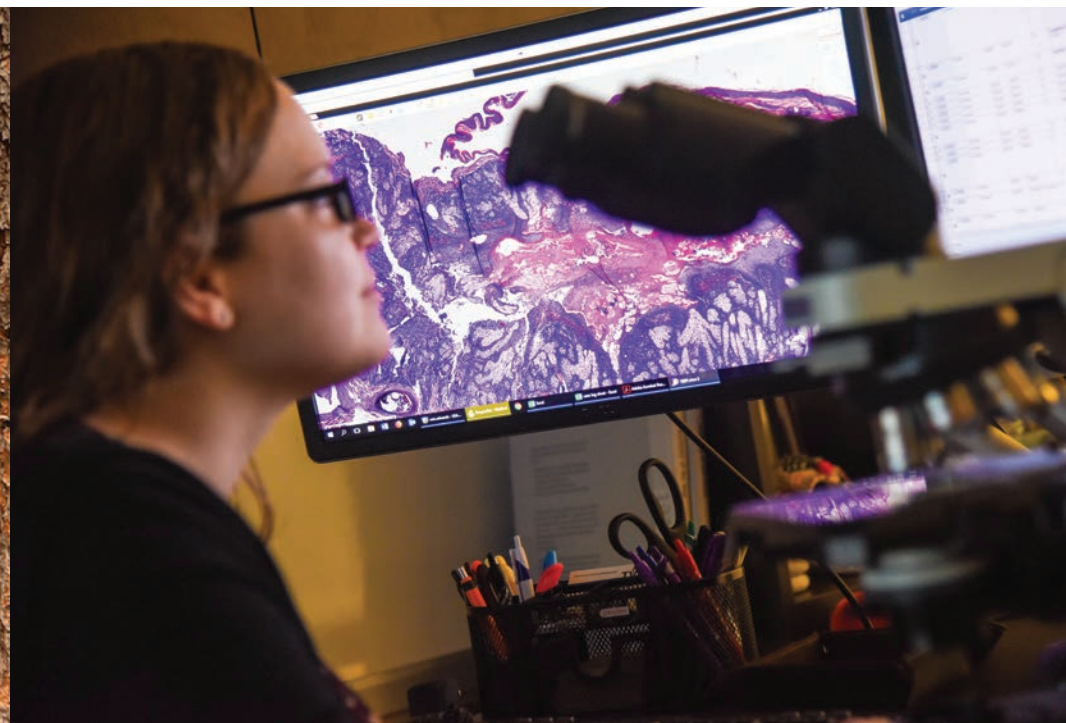

Created in 1915 by the 34th Texas Legislature, **TEXAS A&M FOREST SERVICE** conserves forests and natural resources and protects lives and property.

The state agency is driven by a call to serve, a duty to protect, the commitment to support and the power of partnership. Accordingly, the Texas A&M Forest Service provides technical assistance, program delivery and readily available, easily accessible, science-based information; provides protection against wildland fires and other all-hazard emergencies; promotes statewide forestry-based economic development; builds the capacity of local responders and engages in

cooperative working relationships.

Service knows no bounds as the agency continues more than 100 years of conserving, protecting and leading the state in the interest of the state's forests, trees and related natural resources for the benefit of all.



By testing hundreds of specimens from around the world every day, the **TEXAS A&M VETERINARY MEDICAL DIAGNOSTIC LABORATORY** contributes significantly to protecting the health of livestock, poultry, companion animals, exotic animals, racing animals and wildlife. TVMDL offers more than 700 state-of-the-art diagnostic tests that deliver accurate results promptly and affordably. With four labs located in the state's leading livestock and poultry regions, TVMDL is uniquely situated to serve animal agriculture.

As a Level I Laboratory in the National Animal Health Laboratory Network, TVMDL is among a group of state and regional labs designed to provide a nationwide surge testing, response and recovery capacity. TVMDL also acts as the backbone for a disease surveillance system that protects animal and public health and the agriculture economy.

Animal owners, the agriculture industry and government agencies depend on TVMDL's globally recognized expertise to help preserve animal and public health. The agency has earned accreditation from the American Association of Veterinary Laboratory Diagnosticians, Veterinary Laboratory Investigation and Response Network, Racing Medication & Testing Consortium, and holds ISO17025 Accreditation for Competition Animal Drug Testing.

TEXAS A&M FOREST SERVICE

200 Technology Way, College Station, TX 77845 | 979-458-6606

TEXAS A&M VETERINARY MEDICAL DIAGNOSTIC LABORATORY

483 Agronomy Road | 4471 TAMU, College Station, TX 77843 | 979-845-3414



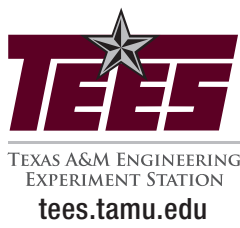

@TEESResearch  
 Texas A&M Engineering Experiment Station

ESTABLISHED .....	1914
REGIONAL DIVISIONS .....	19
LOCAL DIVISIONS .....	15
SPECIALIZED RESEARCH CENTERS .....	29
RESEARCH PROJECTS .....	1,345
RESEARCH EXPENDITURES .....	\$177M
INDUSTRIAL SPONSORS .....	727
UNDERGRADUATE & GRADUATE STUDENTS IN RESEARCH .....	1,672



teex.org

@teexfans @teextweet  
 @teexpics

ESTABLISHED .....	1948
NUMBER OF EDUCATIONAL/OUTREACH CLASSES ANNUALLY .....	6,685
NUMBER OF PEOPLE SERVED ANNUALLY .....	178,063
NUMBER OF COUNTRIES SERVED .....	133



**TEXAS A&M ENGINEERING EXPERIMENT STATION** has been performing quality engineering research and developing technology to address state and national problems for more than 100 years. TEES partners with industries, communities, government agencies, community colleges and universities – in and out of the Texas A&M System – to find solutions to improve quality of life, foster economic development and enhance education. The agency serves as a catalyst for collaborations that position Texas to be especially competitive for federal dollars and plays a major role in strengthening research leadership across the state. TEES also helps improve the state's workforce by engaging over 1,600 undergraduate and graduate students in research each year. Research activities

focus on relevant needs in areas including energy systems and services, safety and security, health care, materials and manufacturing, information systems and sensors, industry outreach, and education and training. The agency serves Texas with headquarters in College Station and specialized research centers and partner institution offices throughout the state.



## TEXAS A&M ENGINEERING EXTENSION SERVICE

helps public and private organizations and communities prepare for, respond to and recover from disasters. Focused on high-quality training and excellent customer service, the agency's programs include fire services, emergency response and recovery, infrastructure, safety, law enforcement, cybersecurity, economic development, and workforce development, led by top-notch instructors with real-world experience. TEEX also sponsors the state's elite urban search and rescue teams, Texas A&M Task Force 1 and Texas Task Force 2.

TEEX offers unparalleled experiential training at world-class facilities across Texas, including Brayton Fire Training Field and Disaster City® in College Station. At the RELLIS Campus in Bryan, TEEX operates outdoor training

grounds and classrooms for infrastructure, law enforcement and explosives courses.

The agency's programs impact a wide and diverse audience through collaborations with other members of The Texas A&M University System, state and federal agencies, the military, private-sector corporations, and the international emergency response community.





tti.tamu.edu

@ttitamu  
 Texas A&M Transportation Institute  
 slideshare.net/TTITAMU

ESTABLISHED .....1950  
 FY 2020 RESEARCH EXPENDITURES .....\$66.9M  
 NUMBER OF RESEARCH  
 PROJECTS ANNUALLY ..... >700  
 LOCATIONS..... 10  
 NUMBER OF STATE AND NATIONAL  
 RESEARCH CENTERS..... 11



**TEXAS A&M TRANSPORTATION INSTITUTE (TTI)** develops solutions to the problems and challenges facing all modes of transportation. TTI conducts over 700 research projects annually with more than 200 sponsors at all levels of government and the private sector. In the laboratory and the classroom, TTI researchers help prepare students for transportation careers.

Recognized as one of the premier higher education-affiliated transportation research agencies in the world, TTI's research and development program has made significant breakthroughs across all facets of the transportation system. TTI research is widely known as an excellent value with a proven impact of saving lives, time and resources.

TTI maintains a full-service safety proving grounds facility; environmental and emissions facility; sediment and erosion control laboratory; visibility research laboratory; and driving simulation laboratory, as well as other laboratories, including pavements, materials and structures labs in the Center for Infrastructure Renewal. TTI has seven urban offices in Texas—Arlington, Austin, Dallas, El Paso, Houston, San Antonio and Waco—and offices in Washington, D.C., and Mexico City, Mexico.

## UNIVERSITIES

Texas A&M University  
Prairie View A&M University  
Tarleton State University  
Texas A&M International University  
Texas A&M University-Corpus Christi  
Texas A&M University-Kingsville  
West Texas A&M University  
Texas A&M University-Commerce  
Texas A&M University-Texarkana  
Texas A&M University-Central Texas  
Texas A&M University-San Antonio

## AGENCIES

Texas A&M AgriLife Research  
Texas A&M Engineering Experiment Station  
Texas A&M AgriLife Extension Service  
Texas A&M Forest Service  
Texas A&M Engineering Extension Service  
Texas A&M Transportation Institute  
Texas Division of Emergency Management  
Texas A&M Veterinary Medical Diagnostic Laboratory

## OTHER MEMBER INSTITUTION

The RELIS Campus



**THE TEXAS A&M UNIVERSITY SYSTEM**

301 Tarrow St., College Station, Texas 77840-7896

[tamus.edu](http://tamus.edu)